

# The Shops at Temple City Plaza

5551-5573 N. Rosemead Blvd. Temple City, CA 91780

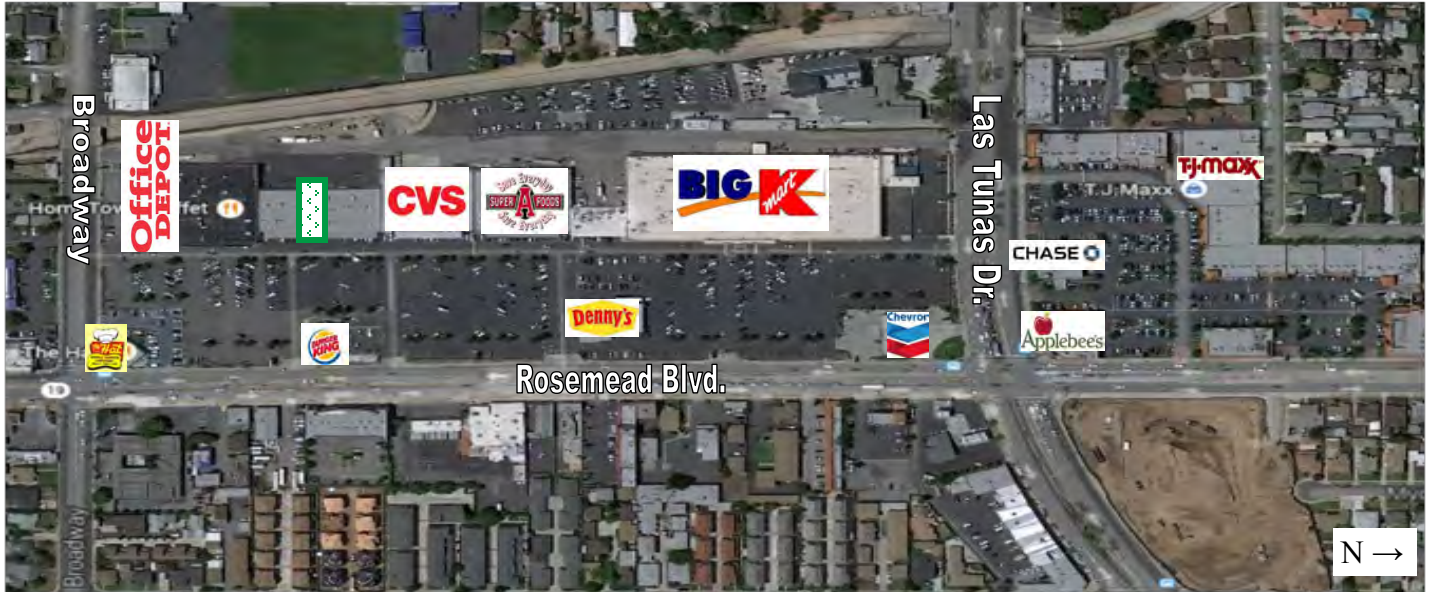

## BUILDING FEATURES:

- Major signalized corner at Las Tunas Dr. and Rosemead Blvd;
- Rosemead Blvd., State Hwy 19, runs North to South connecting Pasadena to Long Beach;
- Co-tenants include Big K Mart, CVS, Burger King, Denny's, Super A Foods, and other regional eateries and retailers;
- TJ Maxx, Applebee's, Chase, Starbucks and other national tenants are in the trade area;
- Ample parking;
- Retail/Restaurant space from 3,765 +/- Sq. Ft.

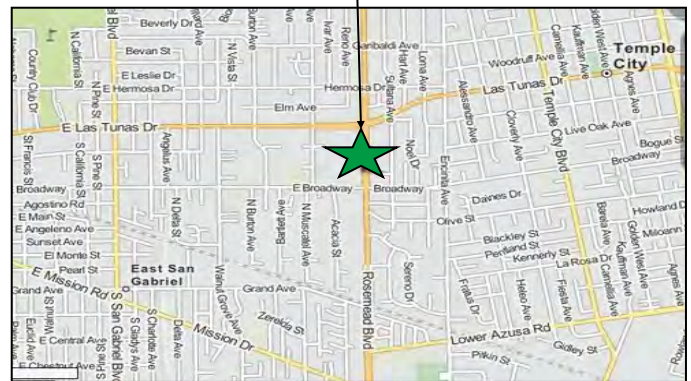
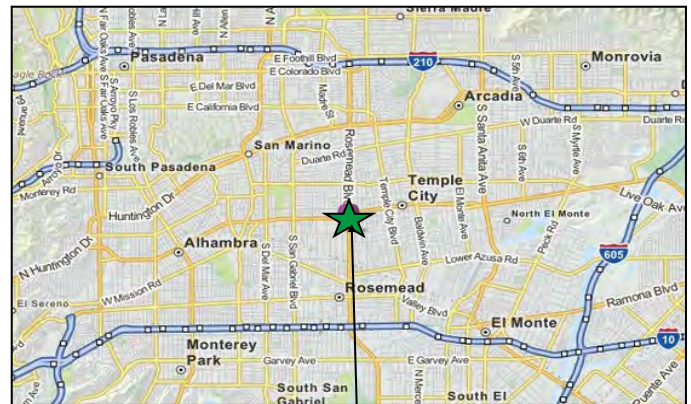

DEMOGRAPHICS Source : CoStar	1-MILE	3-MILE	5-MILE
Population (2018)	29,610	245,076	639,151
Average HH Income (2018)	\$84,845	\$86,710	\$88,475

For more information, please contact BP International, Inc.

**Patsy Ma, MBA, CCIM, CRX, CLS DRE# 00980137**  
patsyma@bpinternational.net

650 W. Duarte Rd., #1088, Arcadia, CA 91007

Tel: 626-821-3448 x 100 Fax: 626-821-9099 www.BPInternational.net

The information contained herein has been obtained from sources that we deem reliable, or the owner of the property. We have no reason to doubt its accuracy, but we do not guarantee it.

# The Shops at Temple City Plaza

5551-5573 N. Rosemead Blvd. Temple City, CA 91780

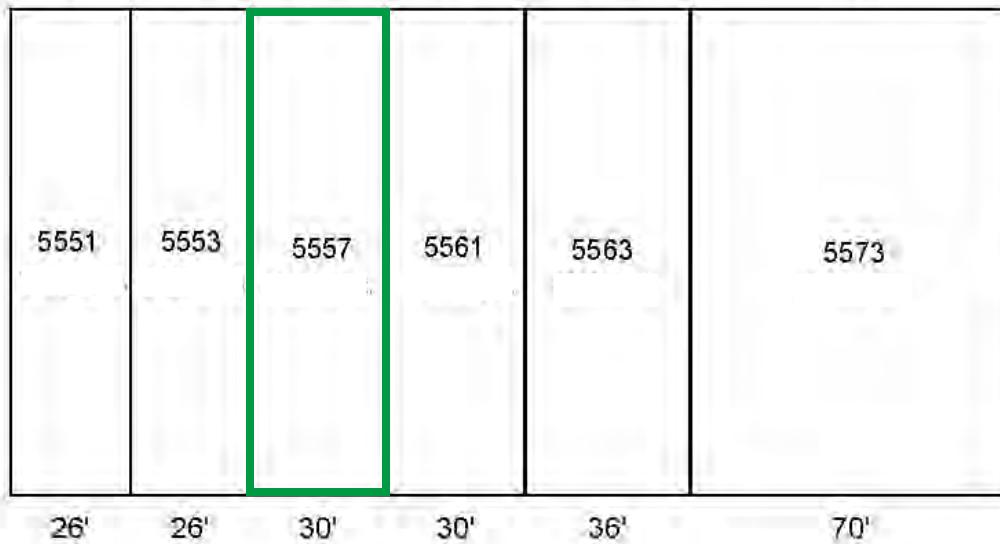

5551-5573 Rosemead Blvd. Temple City

\*Site Plan is not drawn to scale and is subject to change without notice

For more information, please contact BP International, Inc.

**Patsy Ma**, MBA, CCIM, CRX, CLS DRE# 00980137  
patsyma@bpinternational.net

650 W. Duarte Rd., #1088, Arcadia, CA 91007

Tel: 626-821-3448 x 100 Fax: 626-821-9099 [www.BPInternational.net](http://www.BPInternational.net)



# Demographic Detail Report

## The Shops

5551-5573 Rosemead Blvd, Temple City, CA 91780

Building Type: **General Retail**  
 Secondary: -  
 GLA: **23,540 SF**  
 Year Built: **1978**

Total Available: **0 SF**  
 % Leased: **100%**  
 Rent/SF/Yr: -



Radius	1 Mile	3 Mile	5 Mile
<b>Population</b>			
2022 Projection	30,448	251,661	656,799
2017 Estimate	29,610	245,076	639,151
2010 Census	28,468	237,494	616,948
Growth 2017 - 2022	2.83%	2.69%	2.76%
Growth 2010 - 2017	4.01%	3.19%	3.60%
<b>2017 Population by Age</b>			
	<b>29,610</b>	<b>245,076</b>	<b>639,151</b>
Age 0 - 4	1,643 5.55%	13,863 5.66%	38,116 5.96%
Age 5 - 9	1,546 5.22%	13,165 5.37%	35,887 5.61%
Age 10 - 14	1,606 5.42%	13,552 5.53%	35,716 5.59%
Age 15 - 19	1,771 5.98%	14,680 5.99%	37,938 5.94%
Age 20 - 24	1,975 6.67%	16,205 6.61%	42,141 6.59%
Age 25 - 29	2,103 7.10%	17,319 7.07%	46,619 7.29%
Age 30 - 34	1,931 6.52%	16,045 6.55%	44,962 7.03%
Age 35 - 39	1,822 6.15%	15,253 6.22%	42,732 6.69%
Age 40 - 44	1,927 6.51%	16,035 6.54%	43,283 6.77%
Age 45 - 49	2,137 7.22%	17,353 7.08%	44,955 7.03%
Age 50 - 54	2,253 7.61%	18,052 7.37%	45,669 7.15%
Age 55 - 59	2,205 7.45%	17,670 7.21%	44,197 6.91%
Age 60 - 64	1,934 6.53%	15,543 6.34%	38,619 6.04%
Age 65 - 69	1,552 5.24%	12,670 5.17%	31,342 4.90%
Age 70 - 74	1,122 3.79%	9,318 3.80%	22,912 3.58%
Age 75 - 79	802 2.71%	6,886 2.81%	16,737 2.62%
Age 80 - 84	571 1.93%	5,099 2.08%	12,262 1.92%
Age 85+	710 2.40%	6,368 2.60%	15,063 2.36%
Age 65+	4,757 16.07%	40,341 16.46%	98,316 15.38%
<b>Median Age</b>	<b>41.10</b>	<b>40.80</b>	<b>39.50</b>
<b>Average Age</b>	<b>40.30</b>	<b>40.30</b>	<b>39.50</b>



The information contained herein has been obtained from sources that we deem reliable, or the owner of the property. We have no reason to doubt its accuracy, but we do not guarantee it. Copyrighted report licensed to BP International, Inc. - 854092.

5/1/2018

# Demographic Detail Report

## The Shops

5551-5573 Rosemead Blvd, Temple City, CA 91780

Radius	1 Mile	3 Mile	5 Mile
<b>2017 Population By Race</b>	<b>29,610</b>	<b>245,076</b>	<b>639,151</b>
White	11,412 38.54%	100,887 41.17%	324,772 50.81%
Black	351 1.19%	2,914 1.19%	12,955 2.03%
Am. Indian & Alaskan	301 1.02%	2,501 1.02%	7,222 1.13%
Asian	16,907 57.10%	133,923 54.65%	279,072 43.66%
Hawaiian & Pacific Island	32 0.11%	342 0.14%	955 0.15%
Other	606 2.05%	4,508 1.84%	14,175 2.22%
<b>Population by Hispanic Origin</b>	<b>29,610</b>	<b>245,076</b>	<b>639,151</b>
Non-Hispanic Origin	21,719 73.35%	170,059 69.39%	400,717 62.70%
Hispanic Origin	7,891 26.65%	75,017 30.61%	238,434 37.30%
<b>2017 Median Age, Male</b>	<b>38.90</b>	<b>38.70</b>	<b>37.70</b>
<b>2017 Average Age, Male</b>	<b>38.90</b>	<b>38.80</b>	<b>38.10</b>
<b>2017 Median Age, Female</b>	<b>42.90</b>	<b>42.70</b>	<b>41.20</b>
<b>2017 Average Age, Female</b>	<b>41.60</b>	<b>41.60</b>	<b>40.70</b>
<b>2017 Population by Occupation Classification</b>	<b>24,461</b>	<b>201,558</b>	<b>521,850</b>
Civilian Employed	14,217 58.12%	116,290 57.70%	309,786 59.36%
Civilian Unemployed	548 2.24%	5,407 2.68%	15,002 2.87%
Civilian Non-Labor Force	9,683 39.59%	79,799 39.59%	196,913 37.73%
Armed Forces	13 0.05%	62 0.03%	149 0.03%
<b>Households by Marital Status</b>			
Married	5,195	42,488	106,702
Married No Children	2,744	22,918	57,795
Married w/Children	2,452	19,570	48,907
<b>2017 Population by Education</b>	<b>22,633</b>	<b>185,372</b>	<b>479,376</b>
Some High School, No Diploma	3,832 16.93%	39,592 21.36%	100,897 21.05%
High School Grad (Incl Equivalency)	4,912 21.70%	38,456 20.75%	93,285 19.46%
Some College, No Degree	5,212 23.03%	38,990 21.03%	103,582 21.61%
Associate Degree	1,565 6.91%	11,762 6.35%	30,024 6.26%
Bachelor Degree	5,054 22.33%	37,644 20.31%	95,599 19.94%
Advanced Degree	2,058 9.09%	18,928 10.21%	55,989 11.68%



The information contained herein has been obtained from sources that we deem reliable, or the owner of the property. We have no reason to doubt its accuracy, but we do not guarantee it. Copyrighted report licensed to BP International, Inc. - 854092.

5/1/2018

## Demographic Detail Report

<b>The Shops</b>						
5551-5573 Rosemead Blvd, Temple City, CA 91780						
<b>Radius</b>	<b>1 Mile</b>		<b>3 Mile</b>		<b>5 Mile</b>	
<b>2017 Population by Occupation</b>	<b>26,660</b>		<b>219,848</b>		<b>587,737</b>	
Real Estate & Finance	902	3.38%	7,992	3.64%	21,694	3.69%
Professional & Management	6,439	24.15%	54,779	24.92%	154,236	26.24%
Public Administration	638	2.39%	4,773	2.17%	13,543	2.30%
Education & Health	3,099	11.62%	25,400	11.55%	69,265	11.79%
Services	2,762	10.36%	22,305	10.15%	56,967	9.69%
Information	375	1.41%	2,655	1.21%	8,655	1.47%
Sales	4,307	16.16%	32,044	14.58%	79,442	13.52%
Transportation	534	2.00%	4,405	2.00%	13,269	2.26%
Retail	1,600	6.00%	12,617	5.74%	32,329	5.50%
Wholesale	903	3.39%	6,738	3.06%	15,827	2.69%
Manufacturing	1,098	4.12%	12,349	5.62%	32,141	5.47%
Production	923	3.46%	12,362	5.62%	34,608	5.89%
Construction	885	3.32%	6,987	3.18%	19,169	3.26%
Utilities	906	3.40%	6,228	2.83%	15,346	2.61%
Agriculture & Mining	193	0.72%	528	0.24%	1,216	0.21%
Farming, Fishing, Forestry	103	0.39%	378	0.17%	1,024	0.17%
Other Services	993	3.72%	7,308	3.32%	19,006	3.23%
<b>2017 Worker Travel Time to Job</b>	<b>13,570</b>		<b>110,630</b>		<b>294,661</b>	
<30 Minutes	7,259	53.49%	56,825	51.36%	150,821	51.18%
30-60 Minutes	5,027	37.04%	41,611	37.61%	111,009	37.67%
60+ Minutes	1,284	9.46%	12,194	11.02%	32,831	11.14%
<b>2010 Households by HH Size</b>	<b>9,085</b>		<b>74,593</b>		<b>200,516</b>	
1-Person Households	1,571	17.29%	13,149	17.63%	41,814	20.85%
2-Person Households	2,320	25.54%	19,089	25.59%	52,966	26.41%
3-Person Households	1,903	20.95%	14,663	19.66%	36,722	18.31%
4-Person Households	1,677	18.46%	13,229	17.73%	32,525	16.22%
5-Person Households	811	8.93%	7,098	9.52%	17,766	8.86%
6-Person Households	419	4.61%	3,709	4.97%	9,091	4.53%
7 or more Person Households	384	4.23%	3,656	4.90%	9,632	4.80%
<b>2017 Average Household Size</b>	<b>3.10</b>		<b>3.20</b>		<b>3.00</b>	
<b>Households</b>						
2022 Projection	9,714		79,166		213,602	
2017 Estimate	9,444		77,066		207,814	
2010 Census	9,084		74,593		200,517	
Growth 2017 - 2022	2.86%		2.72%		2.79%	
Growth 2010 - 2017	3.96%		3.32%		3.64%	



The information contained herein has been obtained from sources that we deem reliable, or the owner of the property. We have no reason to doubt its accuracy, but we do not guarantee it. Copyrighted report licensed to BP International, Inc. - 854092.

5/1/2018

# Demographic Detail Report

## The Shops

5551-5573 Rosemead Blvd, Temple City, CA 91780

Radius	1 Mile		3 Mile		5 Mile	
<b>2017 Households by HH Income</b>	<b>9,444</b>		<b>77,065</b>		<b>207,813</b>	
<\$25,000	1,839	19.47%	15,743	20.43%	39,919	19.21%
\$25,000 - \$50,000	1,921	20.34%	16,667	21.63%	43,776	21.07%
\$50,000 - \$75,000	1,612	17.07%	11,959	15.52%	34,256	16.48%
\$75,000 - \$100,000	1,289	13.65%	9,254	12.01%	25,793	12.41%
\$100,000 - \$125,000	937	9.92%	7,015	9.10%	19,653	9.46%
\$125,000 - \$150,000	535	5.66%	4,729	6.14%	12,584	6.06%
\$150,000 - \$200,000	695	7.36%	5,814	7.54%	14,969	7.20%
\$200,000+	616	6.52%	5,884	7.64%	16,863	8.11%
<b>2017 Avg Household Income</b>	<b>\$84,845</b>		<b>\$86,710</b>		<b>\$88,475</b>	
<b>2017 Med Household Income</b>	<b>\$65,616</b>		<b>\$62,486</b>		<b>\$64,342</b>	
<b>2017 Occupied Housing</b>	<b>9,444</b>		<b>77,067</b>		<b>207,814</b>	
Owner Occupied	5,391	57.08%	41,514	53.87%	104,768	50.41%
Renter Occupied	4,053	42.92%	35,553	46.13%	103,046	49.59%
<b>2010 Housing Units</b>	<b>9,808</b>		<b>78,796</b>		<b>212,672</b>	
1 Unit	8,078	82.36%	58,852	74.69%	142,462	66.99%
2 - 4 Units	186	1.90%	3,191	4.05%	14,235	6.69%
5 - 19 Units	828	8.44%	8,722	11.07%	30,558	14.37%
20+ Units	716	7.30%	8,031	10.19%	25,417	11.95%
<b>2017 Housing Value</b>	<b>5,391</b>		<b>41,514</b>		<b>104,767</b>	
<\$100,000	80	1.48%	615	1.48%	1,518	1.45%
\$100,000 - \$200,000	11	0.20%	100	0.24%	422	0.40%
\$200,000 - \$300,000	63	1.17%	593	1.43%	3,085	2.94%
\$300,000 - \$400,000	386	7.16%	3,098	7.46%	11,420	10.90%
\$400,000 - \$500,000	848	15.73%	7,211	17.37%	19,055	18.19%
\$500,000 - \$1,000,000	3,623	67.20%	22,660	54.58%	52,567	50.18%
\$1,000,000+	380	7.05%	7,237	17.43%	16,700	15.94%
<b>2017 Median Home Value</b>	<b>\$680,444</b>		<b>\$701,677</b>		<b>\$660,590</b>	
<b>2017 Housing Units by Yr Built</b>	<b>9,837</b>		<b>79,839</b>		<b>215,269</b>	
Built 2010+	327	3.32%	2,454	3.07%	6,100	2.83%
Built 2000 - 2010	354	3.60%	3,354	4.20%	9,968	4.63%
Built 1990 - 1999	564	5.73%	4,275	5.35%	11,379	5.29%
Built 1980 - 1989	676	6.87%	6,563	8.22%	21,323	9.91%
Built 1970 - 1979	999	10.16%	9,259	11.60%	26,106	12.13%
Built 1960 - 1969	1,801	18.31%	12,349	15.47%	32,788	15.23%
Built 1950 - 1959	2,368	24.07%	17,554	21.99%	43,883	20.39%
Built <1949	2,748	27.94%	24,031	30.10%	63,722	29.60%
<b>2017 Median Year Built</b>	<b>1958</b>		<b>1958</b>		<b>1959</b>	



The information contained herein has been obtained from sources that we deem reliable, or the owner of the property. We have no reason to doubt its accuracy, but we do not guarantee it. Copyrighted report licensed to BP International, Inc. - 854092.

5/1/2018