



# Shopping Center for Lease

## Retail Space For Lease

**SWC Pioneer Blvd & Imperial Highway, Norwalk, CA 90650**



### BUILDING FEATURES:

- 12615-12625 Pioneer Blvd., Norwalk, CA 91650;
- Major intersection of Imperial Highway & Pioneer Blvd;
- Daily Traffic Count over 143,000 CPD;
- Just South of Interstate 5 (Santa Ana) Freeway at Pioneer Blvd;
- Anchored by Rally's Hamburgers;
- Easy access to other major freeways: the 605 (San Gabriel) Freeway, the 91 (Riverside) Freeway and Interstate 105 (Century) Freeway;
- Space available: 1,200 +/- Sq. Ft. (Fast-food);
- Across the street from Wal-mart.



DEMOGRAPHICS Source : CoStar (2019)	1-MILE	3-MILE	5-MILE
Population	36,117	221,562	654,748
Average HH Income	\$72,222	\$80,491	\$83,601

For more information, please contact :

**BP International ,Inc.**

**Patsy Ma, MBA, CCIM, CRRP, RX, CLS DRE# 00980137**

**patsyma@bpinternational.net**

**650 W. Duarte Rd., #1088, Arcadia, CA 91007**

**Tel: 626-821-3448 x 100 Fax: 626-821-9099 www.BPInternational.net**

The information contained herein has been obtained from sources that we deem reliable, or the owner of the property. We have no reason to doubt its accuracy, but we do not guarantee it.



# Shopping Center for Lease

SWC Pioneer Blvd & Imperial Highway, Norwalk, CA 91006

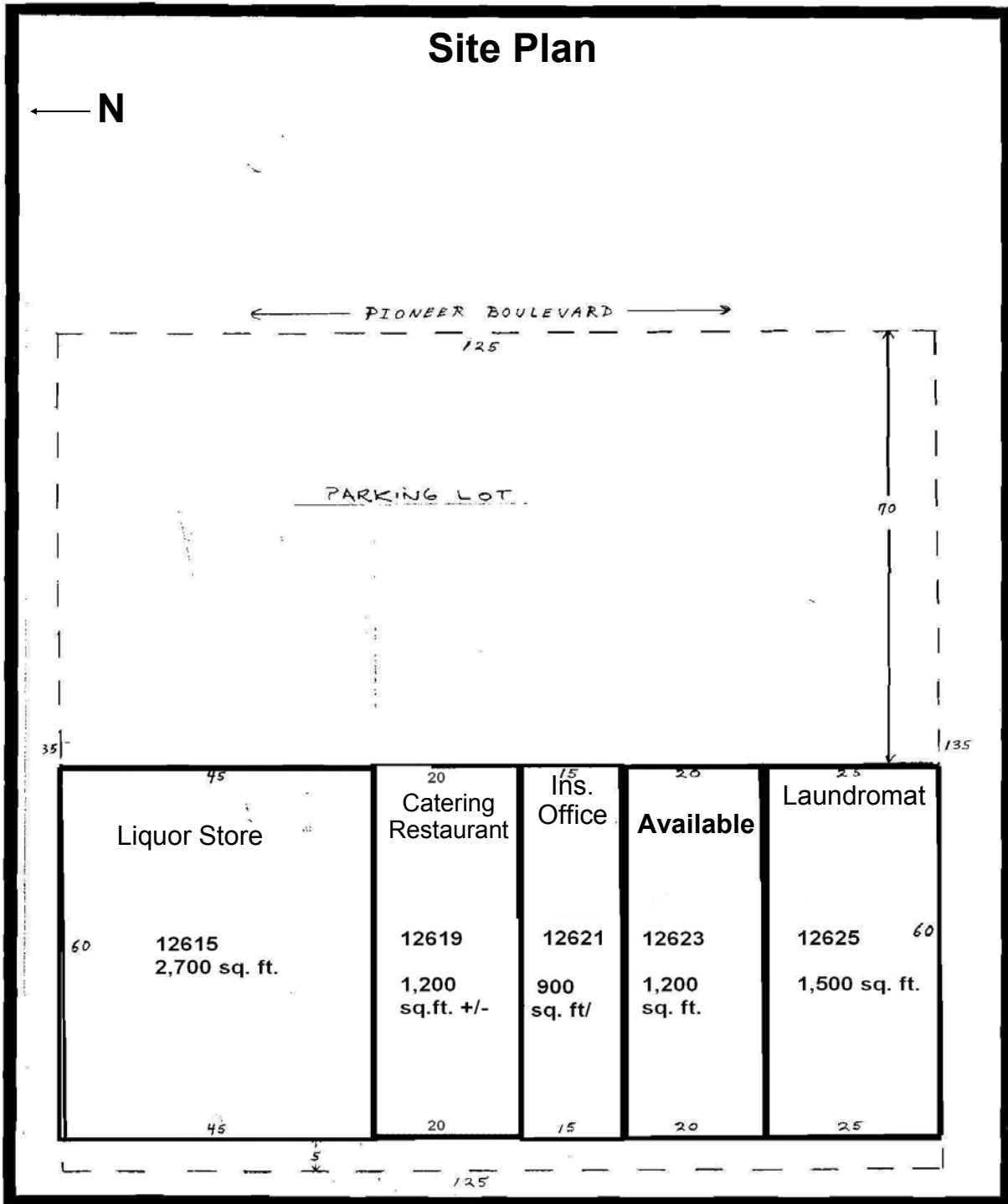

## BP International, Inc.

Patsy Ma, MBA, CCIM, CRX, CLS DRE# 00980137

[patsyma@bpinternational.net](mailto:patsyma@bpinternational.net)

650 W. Duarte Rd., #1088, Arcadia, CA 91007

Tel: 626-821-3448 x 100 Fax: 626-821-9099 [www.BPInternational.net](http://www.BPInternational.net)

The information contained herein has been obtained from sources that we deem reliable, or the owner of the property. We have no reason to doubt its accuracy, but we do not guarantee it.

# Demographic Detail Report

12615-12625 Pioneer Blvd, Norwalk, CA 90650

Building Type: **General Retail**  
 Secondary: **Freestanding**  
 GLA: **7,500 SF**  
 Year Built: **1963**

Total Available: **1,200 SF**  
 % Leased: **84%**  
 Rent/SF/Yr: **\$19.20**



Radius	1 Mile	3 Mile	5 Mile
<b>Population</b>			
2023 Projection	36,508	225,010	665,387
2018 Estimate	36,117	221,562	654,748
2010 Census	36,183	216,349	637,184
Growth 2018 - 2023	1.08%	1.56%	1.62%
Growth 2010 - 2018	-0.18%	2.41%	2.76%
<b>2018 Population by Age</b>			
	<b>36,117</b>	<b>221,562</b>	<b>654,748</b>
Age 0 - 4	2,426 6.72%	15,073 6.80%	43,882 6.70%
Age 5 - 9	2,317 6.42%	14,246 6.43%	41,218 6.30%
Age 10 - 14	2,385 6.60%	14,522 6.55%	41,811 6.39%
Age 15 - 19	2,586 7.16%	15,723 7.10%	45,419 6.94%
Age 20 - 24	2,821 7.81%	17,368 7.84%	50,446 7.70%
Age 25 - 29	2,931 8.12%	18,252 8.24%	52,963 8.09%
Age 30 - 34	2,681 7.42%	16,826 7.59%	48,474 7.40%
Age 35 - 39	2,457 6.80%	15,204 6.86%	43,773 6.69%
Age 40 - 44	2,389 6.61%	14,572 6.58%	42,494 6.49%
Age 45 - 49	2,355 6.52%	14,363 6.48%	42,596 6.51%
Age 50 - 54	2,295 6.35%	13,951 6.30%	42,089 6.43%
Age 55 - 59	2,153 5.96%	13,045 5.89%	39,822 6.08%
Age 60 - 64	1,826 5.06%	11,176 5.04%	34,491 5.27%
Age 65 - 69	1,440 3.99%	8,948 4.04%	27,952 4.27%
Age 70 - 74	1,058 2.93%	6,578 2.97%	20,687 3.16%
Age 75 - 79	772 2.14%	4,673 2.11%	14,637 2.24%
Age 80 - 84	567 1.57%	3,281 1.48%	10,185 1.56%
Age 85+	659 1.82%	3,760 1.70%	11,810 1.80%
Age 65+	4,496 12.45%	27,240 12.29%	85,271 13.02%
<b>Median Age</b>	<b>34.80</b>	<b>34.60</b>	<b>35.40</b>
<b>Average Age</b>	<b>36.40</b>	<b>36.30</b>	<b>36.90</b>



The information contained herein has been obtained from sources that we deem reliable, or the owner of the property. We have no reason to doubt its accuracy, but we do not guarantee it. Copyrighted report licensed to BP International, Inc. - 854092.

2/12/2019

## Demographic Detail Report

12615-12625 Pioneer Blvd, Norwalk, CA 90650

Radius	1 Mile	3 Mile	5 Mile
<b>2018 Population By Race</b>	<b>36,117</b>	<b>221,562</b>	<b>654,748</b>
White	28,571 79.11%	171,641 77.47%	495,956 75.75%
Black	1,650 4.57%	11,806 5.33%	35,496 5.42%
Am. Indian & Alaskan	812 2.25%	4,267 1.93%	11,367 1.74%
Asian	4,093 11.33%	27,719 12.51%	92,456 14.12%
Hawaiian & Pacific Island	178 0.49%	1,076 0.49%	3,449 0.53%
Other	813 2.25%	5,052 2.28%	16,025 2.45%
<b>Population by Hispanic Origin</b>	<b>36,117</b>	<b>221,562</b>	<b>654,748</b>
Non-Hispanic Origin	9,527 26.38%	66,678 30.09%	235,150 35.91%
Hispanic Origin	26,590 73.62%	154,884 69.91%	419,598 64.09%
<b>2018 Median Age, Male</b>	<b>33.60</b>	<b>33.40</b>	<b>34.00</b>
<b>2018 Average Age, Male</b>	<b>35.30</b>	<b>35.20</b>	<b>35.70</b>
<b>2018 Median Age, Female</b>	<b>36.20</b>	<b>36.00</b>	<b>36.80</b>
<b>2018 Average Age, Female</b>	<b>37.60</b>	<b>37.40</b>	<b>38.00</b>
<b>2018 Population by Occupation Classification</b>	<b>28,472</b>	<b>174,577</b>	<b>518,765</b>
Civilian Employed	16,693 58.63%	104,423 59.81%	310,747 59.90%
Civilian Unemployed	861 3.02%	4,694 2.69%	13,529 2.61%
Civilian Non-Labor Force	10,914 38.33%	65,382 37.45%	194,330 37.46%
Armed Forces	4 0.01%	78 0.04%	159 0.03%
<b>Households by Marital Status</b>			
Married	5,219	32,704	102,293
Married No Children	2,517	15,954	51,183
Married w/Children	2,702	16,750	51,109
<b>2018 Population by Education</b>	<b>25,047</b>	<b>153,828</b>	<b>459,109</b>
Some High School, No Diploma	6,435 25.69%	36,134 23.49%	98,941 21.55%
High School Grad (Incl Equivalency)	6,429 25.67%	39,087 25.41%	111,841 24.36%
Some College, No Degree	7,420 29.62%	43,818 28.49%	132,687 28.90%
Associate Degree	1,465 5.85%	9,200 5.98%	27,136 5.91%
Bachelor Degree	2,305 9.20%	18,676 12.14%	61,427 13.38%
Advanced Degree	993 3.96%	6,913 4.49%	27,077 5.90%



The information contained herein has been obtained from sources that we deem reliable, or the owner of the property. We have no reason to doubt its accuracy, but we do not guarantee it. Copyrighted report licensed to BP International, Inc. - 854092.

2/12/2019

# Demographic Detail Report

12615-12625 Pioneer Blvd, Norwalk, CA 90650

Radius	1 Mile		3 Mile		5 Mile	
<b>2018 Population by Occupation</b>	<b>31,107</b>		<b>195,458</b>		<b>585,317</b>	
Real Estate & Finance	941	3.03%	5,811	2.97%	17,316	2.96%
Professional & Management	4,763	15.31%	36,382	18.61%	118,699	20.28%
Public Administration	693	2.23%	4,187	2.14%	12,843	2.19%
Education & Health	3,185	10.24%	21,151	10.82%	67,468	11.53%
Services	2,945	9.47%	18,826	9.63%	55,072	9.41%
Information	409	1.31%	1,637	0.84%	5,590	0.96%
Sales	4,975	15.99%	29,436	15.06%	87,161	14.89%
Transportation	567	1.82%	2,843	1.45%	9,168	1.57%
Retail	1,866	6.00%	12,281	6.28%	36,521	6.24%
Wholesale	878	2.82%	5,383	2.75%	15,354	2.62%
Manufacturing	2,214	7.12%	14,108	7.22%	40,538	6.93%
Production	3,294	10.59%	19,213	9.83%	51,745	8.84%
Construction	1,819	5.85%	9,653	4.94%	25,240	4.31%
Utilities	1,479	4.75%	8,306	4.25%	23,683	4.05%
Agriculture & Mining	122	0.39%	549	0.28%	1,769	0.30%
Farming, Fishing, Forestry	27	0.09%	348	0.18%	1,133	0.19%
Other Services	930	2.99%	5,344	2.73%	16,017	2.74%
<b>2018 Worker Travel Time to Job</b>	<b>16,353</b>		<b>101,943</b>		<b>302,136</b>	
<30 Minutes	8,151	49.84%	53,505	52.49%	159,317	52.73%
30-60 Minutes	6,084	37.20%	37,836	37.11%	111,309	36.84%
60+ Minutes	2,118	12.95%	10,602	10.40%	31,510	10.43%
<b>2010 Households by HH Size</b>	<b>9,511</b>		<b>58,510</b>		<b>182,912</b>	
1-Person Households	1,305	13.72%	8,316	14.21%	28,357	15.50%
2-Person Households	1,969	20.70%	12,302	21.03%	41,691	22.79%
3-Person Households	1,581	16.62%	9,931	16.97%	32,753	17.91%
4-Person Households	1,716	18.04%	10,615	18.14%	34,011	18.59%
5-Person Households	1,265	13.30%	7,575	12.95%	21,912	11.98%
6-Person Households	763	8.02%	4,402	7.52%	11,682	6.39%
7 or more Person Households	912	9.59%	5,369	9.18%	12,506	6.84%
<b>2018 Average Household Size</b>	<b>3.70</b>		<b>3.60</b>		<b>3.40</b>	
<b>Households</b>						
2023 Projection	9,629		61,113		191,491	
2018 Estimate	9,520		60,131		188,348	
2010 Census	9,511		58,509		182,912	
Growth 2018 - 2023	1.14%		1.63%		1.67%	
Growth 2010 - 2018	0.09%		2.77%		2.97%	



The information contained herein has been obtained from sources that we deem reliable, or the owner of the property. We have no reason to doubt its accuracy, but we do not guarantee it. Copyrighted report licensed to BP International, Inc. - 854092.

2/12/2019

# Demographic Detail Report

12615-12625 Pioneer Blvd, Norwalk, CA 90650

Radius	1 Mile	3 Mile	5 Mile
<b>2018 Households by HH Income</b>	<b>9,521</b>	<b>60,129</b>	<b>188,346</b>
<\$25,000	1,615 16.96%	9,572 15.92%	29,506 15.67%
\$25,000 - \$50,000	2,001 21.02%	12,349 20.54%	39,301 20.87%
\$50,000 - \$75,000	2,198 23.09%	12,364 20.56%	35,792 19.00%
\$75,000 - \$100,000	1,617 16.98%	9,419 15.66%	28,920 15.35%
\$100,000 - \$125,000	862 9.05%	6,768 11.26%	20,900 11.10%
\$125,000 - \$150,000	547 5.75%	3,997 6.65%	12,595 6.69%
\$150,000 - \$200,000	519 5.45%	3,184 5.30%	12,062 6.40%
\$200,000+	162 1.70%	2,476 4.12%	9,270 4.92%
<b>2018 Avg Household Income</b>	<b>\$72,222</b>	<b>\$80,491</b>	<b>\$83,601</b>
<b>2018 Med Household Income</b>	<b>\$61,528</b>	<b>\$66,355</b>	<b>\$67,718</b>
<b>2018 Occupied Housing</b>	<b>9,520</b>	<b>60,132</b>	<b>188,348</b>
Owner Occupied	5,891 61.88%	36,390 60.52%	111,879 59.40%
Renter Occupied	3,629 38.12%	23,742 39.48%	76,469 40.60%
<b>2010 Housing Units</b>	<b>9,607</b>	<b>60,814</b>	<b>190,399</b>
1 Unit	7,080 73.70%	45,470 74.77%	140,158 73.61%
2 - 4 Units	380 3.96%	2,074 3.41%	8,140 4.28%
5 - 19 Units	629 6.55%	4,306 7.08%	17,002 8.93%
20+ Units	1,518 15.80%	8,964 14.74%	25,099 13.18%
<b>2018 Housing Value</b>	<b>5,892</b>	<b>36,390</b>	<b>111,879</b>
<\$100,000	144 2.44%	1,005 2.76%	3,068 2.74%
\$100,000 - \$200,000	54 0.92%	427 1.17%	1,019 0.91%
\$200,000 - \$300,000	826 14.02%	3,457 9.50%	7,231 6.46%
\$300,000 - \$400,000	2,845 48.29%	12,738 35.00%	29,412 26.29%
\$400,000 - \$500,000	1,368 23.22%	9,998 27.47%	29,630 26.48%
\$500,000 - \$1,000,000	599 10.17%	8,022 22.04%	38,126 34.08%
\$1,000,000+	56 0.95%	743 2.04%	3,393 3.03%
<b>2018 Median Home Value</b>	<b>\$367,556</b>	<b>\$405,681</b>	<b>\$451,331</b>
<b>2018 Housing Units by Yr Built</b>	<b>9,768</b>	<b>61,965</b>	<b>194,583</b>
Built 2010+	154 1.58%	1,872 3.02%	5,820 2.99%
Built 2000 - 2010	398 4.07%	1,685 2.72%	4,994 2.57%
Built 1990 - 1999	371 3.80%	2,302 3.72%	7,816 4.02%
Built 1980 - 1989	766 7.84%	4,365 7.04%	13,586 6.98%
Built 1970 - 1979	863 8.83%	8,708 14.05%	30,981 15.92%
Built 1960 - 1969	1,255 12.85%	9,690 15.64%	33,426 17.18%
Built 1950 - 1959	4,188 42.87%	24,307 39.23%	68,933 35.43%
Built <1949	1,773 18.15%	9,036 14.58%	29,027 14.92%
<b>2018 Median Year Built</b>	<b>1956</b>	<b>1958</b>	<b>1959</b>



The information contained herein has been obtained from sources that we deem reliable, or the owner of the property. We have no reason to doubt its accuracy, but we do not guarantee it. Copyrighted report licensed to BP International, Inc. - 854092.

2/12/2019