



**International, Inc.**  
**BUSINESS**  
**PROPERTIES**

# Skechers Plaza

## For Lease

**12015 E. Garvey Avenue, El Monte, California**  
**Anchored by Skechers Shoes**

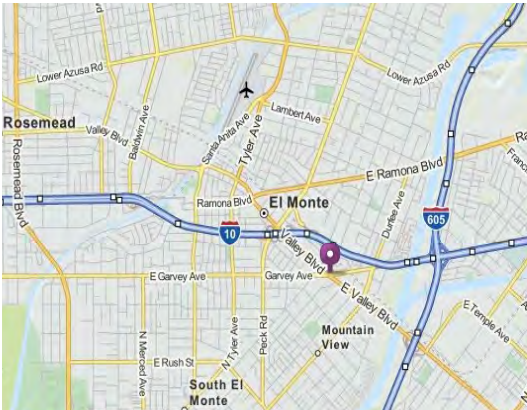

### FEATURES:

- Located at The “Five Points” signalized intersection of Garvey and Valley Boulevard and Cogswell, at the heart of El Monte, approximately 14 miles east of downtown Los Angeles;
- Garvey Avenue & Valley Boulevard are major commercial thoroughfares;
- Major retailers at the intersection include Food4Less, Walgreens, CVS, Chase, Starbucks, Pep Boys & Pizza Hut.
- Easy Access to the 10 (San Bernardino) Freeway and 650 (San Gabriel). Freeway;
- Great pylon signage;
- Excellent on site parking—64 stalls.

Site Plan

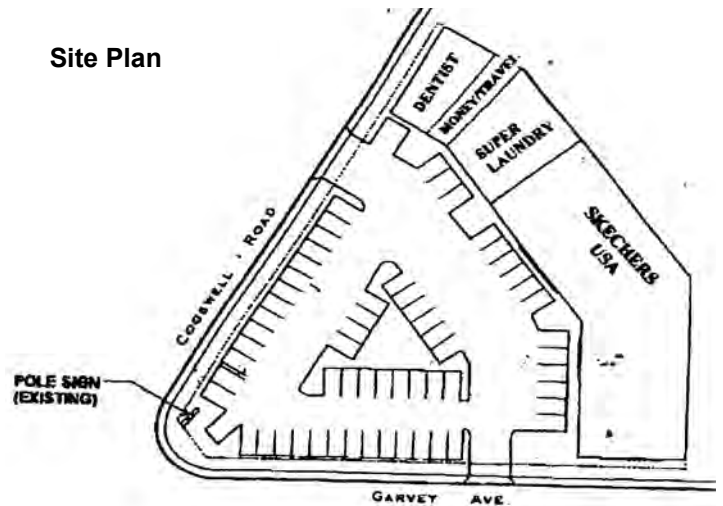

DEMOGRAPHICS Source : CoStar (2018)	1-MILE	3-MILE	5-MILE
Population	42,572	222,433	532,405
Average HH Income	\$47,053	\$56,829	\$63,914

For more information, please contact BP International, Inc.

**Patsy Ma, MBA, CCIM, CRRP, CRX, CLS DRE# 00980137**  
**patsyma@bpinternational.net**

**650 W. Duarte Rd., #1088, Arcadia, CA 91007**

**Tel: 626-821-3448 x 100 Fax: 626-821-9099 www.BPInternational.net**

The information contained herein has been obtained from sources that we deem reliable, or the owner of the property. We have no reason to doubt its accuracy, but we do not guarantee it.

# Demographic Detail Report

## Skechers Plaza 12015 Garvey Ave, El Monte, CA 91732

Building Type: **General Retail**  
 Secondary: **Freestanding**  
 GLA: **16,042 SF**  
 Year Built: **1999**

Total Available: **0 SF**  
 % Leased: **100%**  
 Rent/SF/Yr: **-**



Radius	1 Mile		3 Mile		5 Mile	
<b>Population</b>						
2022 Projection	43,350		235,492		559,103	
2017 Estimate	42,243		229,217		544,427	
2010 Census	41,100		221,570		527,373	
Growth 2017 - 2022	2.62%		2.74%		2.70%	
Growth 2010 - 2017	2.78%		3.45%		3.23%	
<b>2017 Population by Age</b>						
	<b>42,243</b>		<b>229,217</b>		<b>544,427</b>	
Age 0 - 4	3,037	7.19%	15,427	6.73%	34,474	6.33%
Age 5 - 9	3,096	7.33%	15,389	6.71%	33,678	6.19%
Age 10 - 14	3,169	7.50%	15,790	6.89%	34,861	6.40%
Age 15 - 19	3,321	7.86%	16,724	7.30%	37,752	6.93%
Age 20 - 24	3,559	8.43%	18,172	7.93%	41,428	7.61%
Age 25 - 29	3,703	8.77%	19,021	8.30%	43,220	7.94%
Age 30 - 34	3,374	7.99%	17,349	7.57%	38,918	7.15%
Age 35 - 39	3,008	7.12%	15,725	6.86%	35,535	6.53%
Age 40 - 44	2,847	6.74%	15,222	6.64%	35,435	6.51%
Age 45 - 49	2,746	6.50%	14,898	6.50%	36,276	6.66%
Age 50 - 54	2,544	6.02%	14,257	6.22%	36,187	6.65%
Age 55 - 59	2,240	5.30%	13,230	5.77%	34,443	6.33%
Age 60 - 64	1,793	4.24%	11,235	4.90%	29,617	5.44%
Age 65 - 69	1,344	3.18%	8,933	3.90%	23,737	4.36%
Age 70 - 74	912	2.16%	6,423	2.80%	17,242	3.17%
Age 75 - 79	634	1.50%	4,617	2.01%	12,531	2.30%
Age 80 - 84	440	1.04%	3,275	1.43%	9,012	1.66%
Age 85+	476	1.13%	3,530	1.54%	10,080	1.85%
Age 65+	3,806	9.01%	26,778	11.68%	72,602	13.34%
<b>Median Age</b>	<b>31.80</b>		<b>34.10</b>		<b>36.10</b>	
<b>Average Age</b>	<b>33.70</b>		<b>35.80</b>		<b>37.30</b>	



The information contained herein has been obtained from sources that we deem reliable, or the owner of the property. We have no reason to doubt its accuracy, but we do not guarantee it. Copyrighted report licensed to BP International, Inc. - 854092.

5/2/2018

## Demographic Detail Report

<b>Skechers Plaza</b>						
12015 Garvey Ave, El Monte, CA 91732						
<b>Radius</b>	<b>1 Mile</b>		<b>3 Mile</b>		<b>5 Mile</b>	
<b>2017 Population By Race</b>	<b>42,243</b>		<b>229,217</b>		<b>544,427</b>	
White	31,488	74.54%	167,359	73.01%	352,497	64.75%
Black	548	1.30%	2,882	1.26%	8,893	1.63%
Am. Indian & Alaskan	898	2.13%	4,094	1.79%	8,534	1.57%
Asian	8,597	20.35%	50,833	22.18%	163,889	30.10%
Hawaiian & Pacific Island	77	0.18%	501	0.22%	1,017	0.19%
Other	635	1.50%	3,547	1.55%	9,598	1.76%
<b>Population by Hispanic Origin</b>	<b>42,243</b>		<b>229,217</b>		<b>544,427</b>	
Non-Hispanic Origin	9,705	22.97%	64,062	27.95%	214,949	39.48%
Hispanic Origin	32,538	77.03%	165,155	72.05%	329,477	60.52%
<b>2017 Median Age, Male</b>	<b>31.20</b>		<b>33.10</b>		<b>34.60</b>	
<b>2017 Average Age, Male</b>	<b>33.00</b>		<b>34.80</b>		<b>36.20</b>	
<b>2017 Median Age, Female</b>	<b>32.50</b>		<b>35.10</b>		<b>37.60</b>	
<b>2017 Average Age, Female</b>	<b>34.40</b>		<b>36.70</b>		<b>38.40</b>	
<b>2017 Population by Occupation Classification</b>	<b>32,272</b>		<b>179,269</b>		<b>433,871</b>	
Civilian Employed	18,528	57.41%	102,383	57.11%	250,413	57.72%
Civilian Unemployed	1,312	4.07%	6,585	3.67%	15,343	3.54%
Civilian Non-Labor Force	12,422	38.49%	70,242	39.18%	167,873	38.69%
Armed Forces	10	0.03%	59	0.03%	242	0.06%
<b>Households by Marital Status</b>						
Married	5,313		31,773		82,026	
Married No Children	2,120		15,177		41,573	
Married w/Children	3,193		16,596		40,453	
<b>2017 Population by Education</b>	<b>28,232</b>		<b>157,863</b>		<b>386,864</b>	
Some High School, No Diploma	11,859	42.01%	58,399	36.99%	116,085	30.01%
High School Grad (Incl Equivalency)	7,336	25.98%	40,467	25.63%	95,425	24.67%
Some College, No Degree	4,051	14.35%	29,908	18.95%	81,529	21.07%
Associate Degree	2,172	7.69%	10,150	6.43%	24,630	6.37%
Bachelor Degree	2,391	8.47%	14,503	9.19%	49,801	12.87%
Advanced Degree	423	1.50%	4,436	2.81%	19,394	5.01%



The information contained herein has been obtained from sources that we deem reliable, or the owner of the property. We have no reason to doubt its accuracy, but we do not guarantee it. Copyrighted report licensed to BP International, Inc. - 854092.

5/2/2018

## Demographic Detail Report

<b>Skechers Plaza</b>						
12015 Garvey Ave, El Monte, CA 91732						
<b>Radius</b>	<b>1 Mile</b>		<b>3 Mile</b>		<b>5 Mile</b>	
<b>2017 Population by Occupation</b>	<b>34,541</b>		<b>192,640</b>		<b>471,026</b>	
Real Estate & Finance	723	2.09%	4,575	2.37%	13,152	2.79%
Professional & Management	4,387	12.70%	28,841	14.97%	86,687	18.40%
Public Administration	519	1.50%	3,437	1.78%	9,164	1.95%
Education & Health	2,637	7.63%	16,745	8.69%	47,365	10.06%
Services	4,716	13.65%	23,485	12.19%	53,056	11.26%
Information	279	0.81%	1,610	0.84%	4,395	0.93%
Sales	4,265	12.35%	25,093	13.03%	66,589	14.14%
Transportation	1,164	3.37%	5,316	2.76%	10,378	2.20%
Retail	2,233	6.46%	12,289	6.38%	29,770	6.32%
Wholesale	1,416	4.10%	6,278	3.26%	15,073	3.20%
Manufacturing	2,917	8.45%	16,559	8.60%	34,559	7.34%
Production	4,665	13.51%	23,238	12.06%	44,545	9.46%
Construction	2,018	5.84%	10,400	5.40%	21,442	4.55%
Utilities	1,039	3.01%	6,000	3.11%	14,827	3.15%
Agriculture & Mining	159	0.46%	779	0.40%	1,823	0.39%
Farming, Fishing, Forestry	199	0.58%	736	0.38%	1,496	0.32%
Other Services	1,205	3.49%	7,259	3.77%	16,705	3.55%
<b>2017 Worker Travel Time to Job</b>	<b>17,889</b>		<b>98,339</b>		<b>240,493</b>	
<30 Minutes	7,862	43.95%	47,126	47.92%	118,350	49.21%
30-60 Minutes	7,709	43.09%	38,915	39.57%	92,537	38.48%
60+ Minutes	2,318	12.96%	12,298	12.51%	29,606	12.31%
<b>2010 Households by HH Size</b>	<b>9,597</b>		<b>54,032</b>		<b>139,332</b>	
1-Person Households	919	9.58%	5,822	10.78%	17,962	12.89%
2-Person Households	1,391	14.49%	9,434	17.46%	28,248	20.27%
3-Person Households	1,518	15.82%	8,949	16.56%	24,850	17.84%
4-Person Households	1,881	19.60%	10,052	18.60%	25,674	18.43%
5-Person Households	1,613	16.81%	7,883	14.59%	17,975	12.90%
6-Person Households	945	9.85%	4,825	8.93%	10,482	7.52%
7 or more Person Households	1,330	13.86%	7,067	13.08%	14,141	10.15%
<b>2017 Average Household Size</b>	<b>4.20</b>		<b>4.00</b>		<b>3.70</b>	
<b>Households</b>						
2022 Projection	10,285		58,199		148,880	
2017 Estimate	9,997		56,525		144,779	
2010 Census	9,596		54,031		139,333	
Growth 2017 - 2022	2.88%		2.96%		2.83%	
Growth 2010 - 2017	4.18%		4.62%		3.91%	



The information contained herein has been obtained from sources that we deem reliable, or the owner of the property. We have no reason to doubt its accuracy, but we do not guarantee it. Copyrighted report licensed to BP International, Inc. - 854092.

5/2/2018

## Demographic Detail Report

<b>Skechers Plaza</b>					
12015 Garvey Ave, El Monte, CA 91732					
Radius	1 Mile		3 Mile		5 Mile
<b>2017 Households by HH Income</b>	<b>9,995</b>		<b>56,525</b>		<b>144,779</b>
<\$25,000	2,977	29.78%	12,475	22.07%	27,507 19.00%
\$25,000 - \$50,000	3,412	34.14%	16,403	29.02%	35,979 24.85%
\$50,000 - \$75,000	1,465	14.66%	10,269	18.17%	26,623 18.39%
\$75,000 - \$100,000	914	9.14%	7,007	12.40%	19,496 13.47%
\$100,000 - \$125,000	577	5.77%	4,422	7.82%	13,568 9.37%
\$125,000 - \$150,000	263	2.63%	2,365	4.18%	7,414 5.12%
\$150,000 - \$200,000	236	2.36%	2,266	4.01%	8,074 5.58%
\$200,000+	151	1.51%	1,318	2.33%	6,118 4.23%
<b>2017 Avg Household Income</b>	<b>\$53,484</b>		<b>\$65,156</b>		<b>\$75,738</b>
<b>2017 Med Household Income</b>	<b>\$38,735</b>		<b>\$48,828</b>		<b>\$57,817</b>
<b>2017 Occupied Housing</b>	<b>9,996</b>		<b>56,525</b>		<b>144,779</b>
Owner Occupied	3,293	32.94%	29,894	52.89%	85,803 59.26%
Renter Occupied	6,703	67.06%	26,631	47.11%	58,976 40.74%
<b>2010 Housing Units</b>	<b>10,233</b>		<b>56,620</b>		<b>146,393</b>
1 Unit	6,696	65.44%	44,681	78.91%	119,442 81.59%
2 - 4 Units	792	7.74%	2,778	4.91%	5,445 3.72%
5 - 19 Units	1,594	15.58%	4,654	8.22%	9,645 6.59%
20+ Units	1,151	11.25%	4,507	7.96%	11,861 8.10%
<b>2017 Housing Value</b>	<b>3,293</b>		<b>29,893</b>		<b>85,803</b>
<\$100,000	97	2.95%	1,080	3.61%	2,210 2.58%
\$100,000 - \$200,000	29	0.88%	411	1.37%	1,082 1.26%
\$200,000 - \$300,000	504	15.31%	3,750	12.54%	8,602 10.03%
\$300,000 - \$400,000	1,225	37.20%	8,871	29.68%	20,640 24.06%
\$400,000 - \$500,000	789	23.96%	7,000	23.42%	18,880 22.00%
\$500,000 - \$1,000,000	557	16.91%	7,637	25.55%	28,356 33.05%
\$1,000,000+	92	2.79%	1,144	3.83%	6,033 7.03%
<b>2017 Median Home Value</b>	<b>\$382,979</b>		<b>\$411,921</b>		<b>\$454,912</b>
<b>2017 Housing Units by Yr Built</b>	<b>10,544</b>		<b>58,793</b>		<b>149,963</b>
Built 2010+	463	4.39%	2,816	4.79%	5,915 3.94%
Built 2000 - 2010	309	2.93%	2,406	4.09%	5,184 3.46%
Built 1990 - 1999	903	8.56%	3,344	5.69%	8,552 5.70%
Built 1980 - 1989	1,808	17.15%	6,162	10.48%	14,701 9.80%
Built 1970 - 1979	1,315	12.47%	7,575	12.88%	18,790 12.53%
Built 1960 - 1969	2,266	21.49%	11,313	19.24%	26,970 17.98%
Built 1950 - 1959	1,879	17.82%	14,645	24.91%	41,023 27.36%
Built <1949	1,601	15.18%	10,532	17.91%	28,828 19.22%
<b>2017 Median Year Built</b>	<b>1967</b>		<b>1963</b>		<b>1961</b>



The information contained herein has been obtained from sources that we deem reliable, or the owner of the property. We have no reason to doubt its accuracy, but we do not guarantee it.  
Copyrighted report licensed to BP International, Inc. - 854092.

5/2/2018